



DIRECT-REPLACEMENT
INSTALLATION GUIDE

TOYOTA TUNDRA (2007-2020)

PERFORMANCE ELITE SERIES 2.5 DUAL SPEED COMPRESSION

883-06-186 - Kit: 07-20 Toyota Tundra, Front, 2.5 Truck PES, R/R, 2" Lift, DSC

883-06-187 - Kit: 07-20 Toyota Tundra, w/ UCA, Front, 2.5 Truck PES, R/R, 2-3" Lift, DSC

CONTENTS

INTRODUCTION	1
SUPPLIED PARTS	2
SHOCK DIAGRAM	3
SAFETY INSTRUCTIONS	4
INSTALLATION GUIDELINES	5
FRONT SHOCK INSTALLATION	6
FOX FACTORY DSC	12
WARRANTY INFORMATION	13
SHOCKS NEED LOVE TOO	14

INTRODUCTION

Thank you for choosing FOX direct-replacement shocks for your vehicle. FOX products are designed, tested, and manufactured by the finest professionals in the industry.

FOX recommends that you become completely familiar with the handling characteristics of your modified vehicle before operating it under rigorous conditions, helping to avoid potential rollover situations and other loss of control events. FOX further recommends that you use appropriate protective equipment at all times when operating your vehicle.

To achieve the best performance and product longevity, periodic service and maintenance is required. Please refer to the Service and Upgrades section for more information.

IN THE BOX

- Reservoir Mounts
- Front Shocks
- Supplied Hardware
- Installation Guide

SUPPLIED PARTS

SHOCK ASSEMBLY				
FOX PN	DESCRIPTION		QTY	NOTES
983-06-186-L/R	FRONT, LEFT/RIGHT SHOCK		2	2" Lift
983-06-187-L/R	FRONT, LEFT/RIGHT SHOCK		2	2-3" Lift w/ UCA
FRONT TOP HAT HARDWARE				
FOX PN	DESCRIPTION	*HARDWARE REF.	QTY	NOTES
018-05-030-A	WASHER: M10	A1	8	Each top hat uses four washers and four nuts.
019-00-013	HEX NUT: M10 X 1.25"	A2	8	
FRONT RESERVOIR BRACKET ASSEMBLY				
FOX PN	DESCRIPTION	*HARDWARE REF.	QTY	NOTES
026-01-228	FRONT RESERVOIR BRACKET	B	2	Brackets mount the remote reservoirs to the vehicle.
018-01-066	SCREW: 8-32, 3/4"	C1	8	Each bracket uses two clamps and a clamp uses two screws.
026-01-167-1	2.5 RESERVOIR CLAMP, TOP	C2	4	
026-01-167-2	2.5 RESERVOIR CLAMP, BOTTOM	C3	4	

*Hardware Reference is used throughout the installation manual to provide notation of the supplied kit.

SHOCK DIAGRAM

FRONT SHOCK

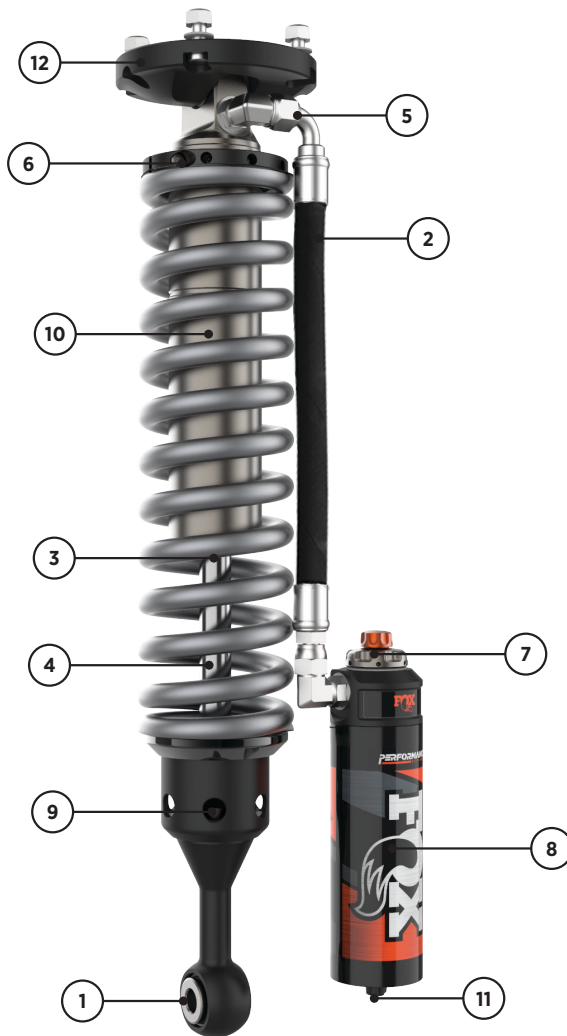

PART NO.	NAME	PART NO.	NAME
1	Eyelet	7	DSC adjuster
2	Hose	8	Reservoir
3	Wiper seal	9	Bumper
4	Shaft	10	Shock body
5	Hose coupler	11	Schrader valve
6	Preload ring	12	Top hat

WARNING

SAFETY INSTRUCTIONS

- FOX direct-replacement shocks are designed to fit and allow proper clearance with the stock suspension. If aftermarket suspension components are installed it is the customer's responsibility to ensure that interference between the FOX shocks and other vehicle components does not occur at any point in the shock stroke.
- FOX direct-replacement shocks should always be installed as a set for maximum performance.
- Proper installation and service procedures are essential for the safe and reliable operation of the suspension components, requiring the experience and tools specially designed for this purpose. Installation and maintenance procedures for this product must be performed by a qualified service technician, to avoid potentially unsafe vehicle handling characteristics, which may result in **SERIOUS INJURY** or **DEATH**.
- Modifying your vehicle's suspension will change the handling characteristics of your vehicle. Under certain conditions, your modified vehicle may be more susceptible to loss of control or rollover, which can result in **SERIOUS INJURY** or **DEATH**. Thoroughly familiarize yourself with the modified vehicle handling characteristics before any rigorous vehicle operation. Wear protective body gear and a helmet when appropriate. Installation of vehicle roll bars or cage is highly recommended.
- FOX direct-replacement shocks are gas-charged and are highly pressurized. Placing shocks in a vise or clamp, applying heat, or attempting to open or service the shock without the proper tools and training can result in **SERIOUS INJURY** or **DEATH**. Do not attempt to modify, puncture or incinerate a FOX direct-replacement shock absorber.
- Any attempt to misuse, misapply, modify, or tamper with any FOX product voids any warranty and may result in **SERIOUS INJURY** or **DEATH**.

WARNING

INSTALLATION GUIDELINES

- Always use a chassis lift for the installation of shocks, and make certain that the raised vehicle is securely attached to the lift to prevent the vehicle from slipping, falling, or moving during the installation process.
- DO NOT install any FOX product without the necessary special tools, expertise and chassis lift or you will subject yourself to the risk of SERIOUS INJURY or DEATH. If you elect to not use a chassis lift (which may result in SERIOUS INJURY or DEATH), ensure that the vehicle is: (1) on level ground, (2) that all tires on the ground during installation are blocked to prevent vehicle movement, (3) that at least two tires are on the ground at all times, and (4) that adequately secured jack stands are used to support the vehicle. NEVER get under the vehicle until you have checked to ensure that the vehicle will be stable during installation.
- FOX direct-replacement shocks are designed to fit your vehicle's shock mounts without modification except the reservoir placement on specific models and applications.
- If a preload adjustment is necessary for your application DO NOT adjust preload with the coil-over on the vehicle. Remove the coil-over from the vehicle and use a spring compressor to remove the lower spring hardware and spring. Once the spring is removed, you can adjust the preload ring. DO NOT Exceed more the 1/2" of additional preload. If more than 1/2" of preload is required, you will need to go up in spring rate or get a longer spring that fits the application.

FRONT SHOCK INSTALLATION

TOOLS REQUIRED

- Manufacturer Torque Specs
- Torque Wrench
- Medium-Strength Thread-Lock

NOTICE: Medium-strength thread-lock is recommended on all bolts.

1. Please read the installation guidelines on page 5 for instructions on how to properly lift and secure the vehicle.
2. Record the front vehicle ride height to ensure the proper lift is attained after kit is installed. READ INSTALLATION GUIDELINES ON HOW TO PROPERLY ADJUST PRELOAD.

STOCK SHOCK REMOVAL

3. Remove front wheels from vehicle.
4. Disconnect both outer tie rod ends at the spindle steering arm for removal/installation clearance (Fig. 1).



Fig. 1: Tie rod castle nut.

5. Disconnect the sway bar from both lower control arms (Fig. 2).



Fig. 2: Disconnect the sway bar end link.

6. Remove the four bolts that secure the sway bar to the vehicle frame (Fig. 3). Move sway bar forward to allow clearance for shock removal.

NOTICE: Do not discard bolts. They will be used with your new FOX coil-over assembly.

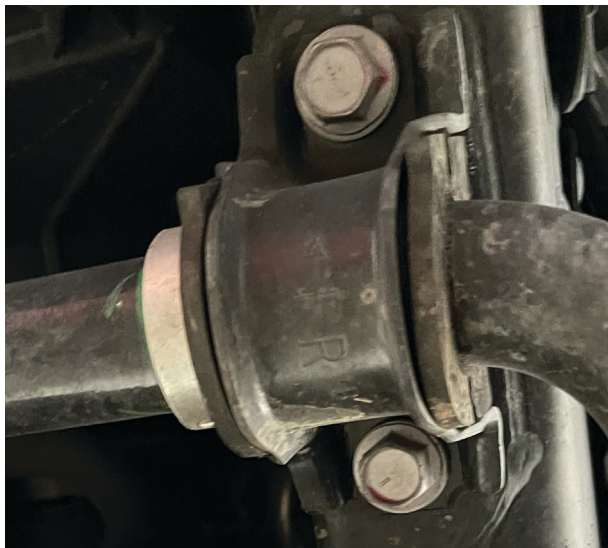

Fig. 3a: Remove sway bar bolts.

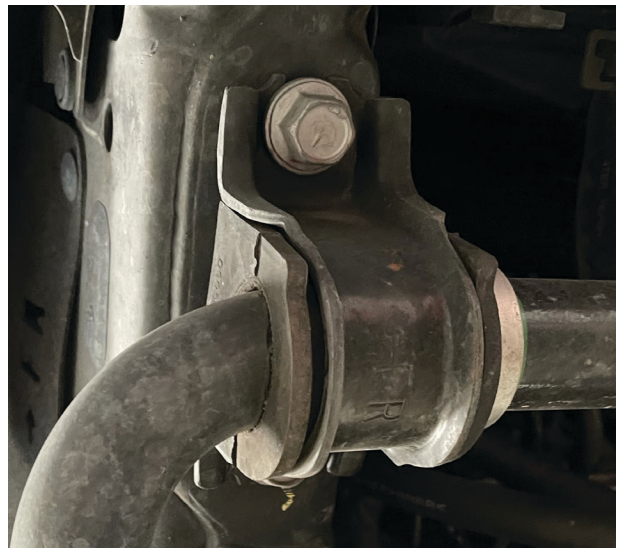

Fig. 3b: Remove sway bar bolts.

7. Remove the four top nuts that secure the stock shock assembly to the vehicle (Fig. 4). DO NOT remove center nut. Removal of the center nut will release the spring from the stock assembly and may result in SERIOUS INJURY or DEATH!

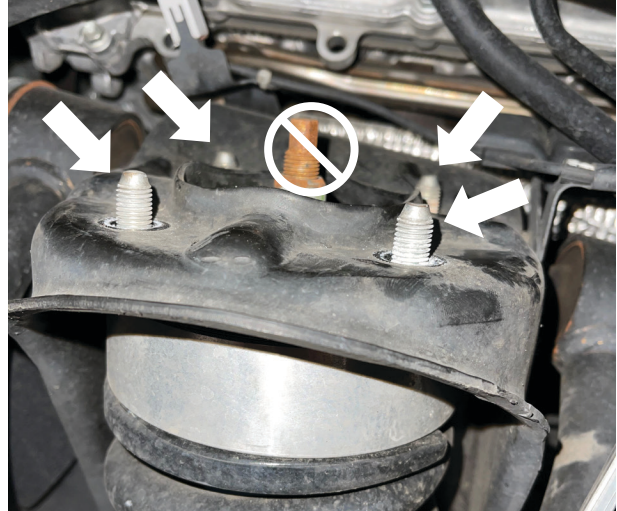

Fig. 4: Remove top hat nuts.

8. Remove the bolt connecting the shock to the lower control arm (Fig. 5).

NOTICE: Do not discard bolts. They will be used with your new FOX coil-over assembly, depending on model.



Fig. 5: Remove bolt on lower shock mount.

9. Loosening the nut connecting the upper control arm to the spindle might be necessary (Fig. 6). If you're installing an aftermarket upper control arm (UCA) for part number 883-06-187, install the UCA with the company's required specifications. Once installed, continue to step 10.



Fig. 6: Loosen upper control arm castle nut.

10. Remove the stock shock assembly. A pry bar might be needed to pull on the upper control arm and lower the suspension to allow the removal of the stock shock. Be careful not to damage any brake lines or electrical wires.

FOX COIL-OVER INSTALL

11. Install the new coil-over assembly. With remote reservoir models, make sure that the hoses are facing outward and toward the front of the vehicle (Fig. 7a). Double check the top hat is installed correctly. For the driver-side shock, the machined flat faces the rear of the vehicle. For the passenger-side shock, the machined flat faces the front of the vehicle (Fig. 7b). Connect the top shock hat to the vehicle with the provided Group A nuts and washers. Tighten all four top nuts to 24 ft/lbs.

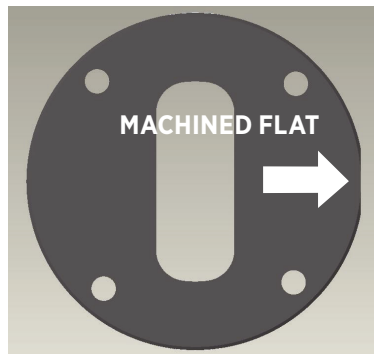

Fig. 7b: Machined flat on top hat.

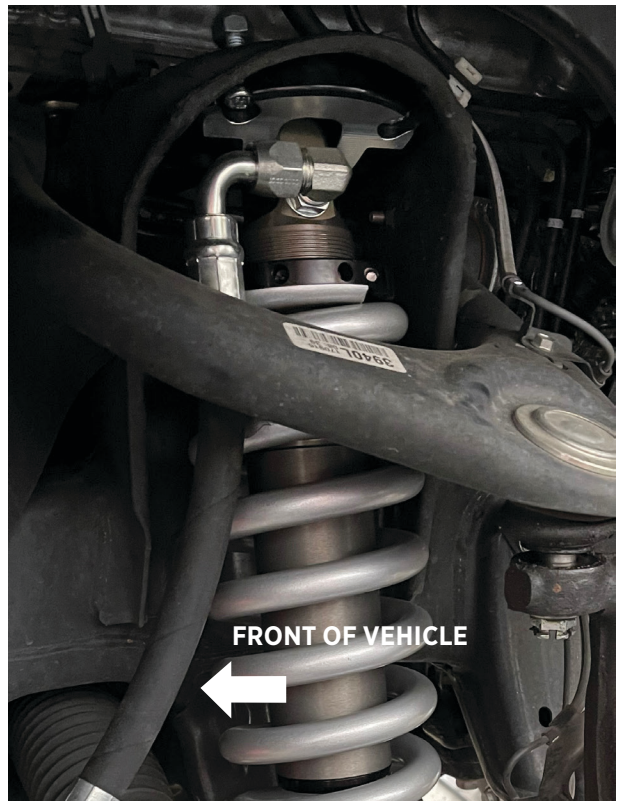

Fig. 7a: Install FOX shock assembly.

12. Connect the shock to the lower control arm and reuse the factory lower bolt and nut. Torque to OE specifications.

RESERVOIR BRACKET INSTALLATION

13. On external reservoir models, reuse the factory sway bar bolts to install the Group B reservoir bracket between the sway bar and vehicle frame (Fig. 8). Slide the bracket against the vehicle frame and torque to OE specifications.

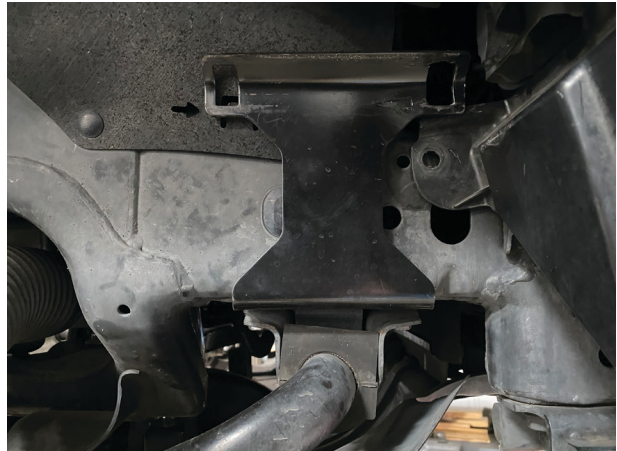

Fig. 8: Install the reservoir bracket.

14. Mount the reservoir to the brackets using the Group C reservoir clamps. Utilize the slots in the bracket to locate the clamps. Do not feed the clamps through the slots in the bracket (Fig. 9a). Once installed, the reservoir should look like (Fig. 9b).

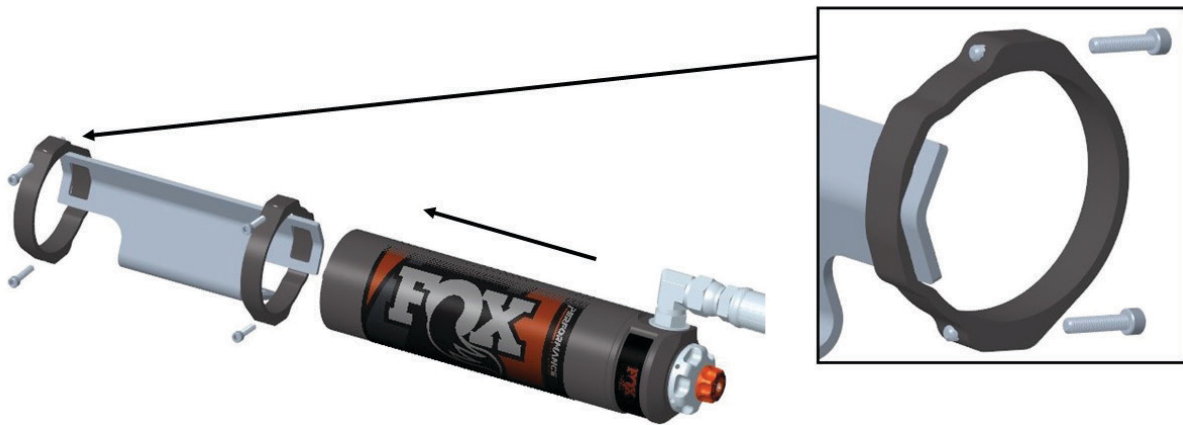

Fig. 9a: Mount the reservoir flush to the bracket.



Fig. 9b: Reservoir mounted to vehicle.

15. Connect the sway bar to the lower control arm and torque to OE specifications.

NOTICE: The vehicle may need to be on the ground to reinstall the sway bar bolts.

16. Reinstall the outer tie rod ends and torque to OE specifications. Do not forget the cotter pin (Fig 10).



Fig. 10: Reinstall the tie rod end link.

17. Reinstall both front wheels and torque to OE specifications.

CHECK AND FINAL DETAILS

18. Check that the suspension has proper clearance by steering completely in both directions.

19. Set vehicle back on the ground and drive it back and forth several feet to allow the suspension to settle. Now measure ride height and adjust if necessary. READ INSTALLATION GUIDELINES ON HOW TO PROPERLY ADJUST PRELOAD.

20. If you have not already re-installed the sway bar, install it now. Torque to OE specifications.

21. It is highly recommended that you have your wheel alignment checked.

FOX FACTORY DSC

DUAL SPEED COMPRESSION (DSC) ADJUSTER SETTINGS

DSC HIGH SPEED COMPRESSION

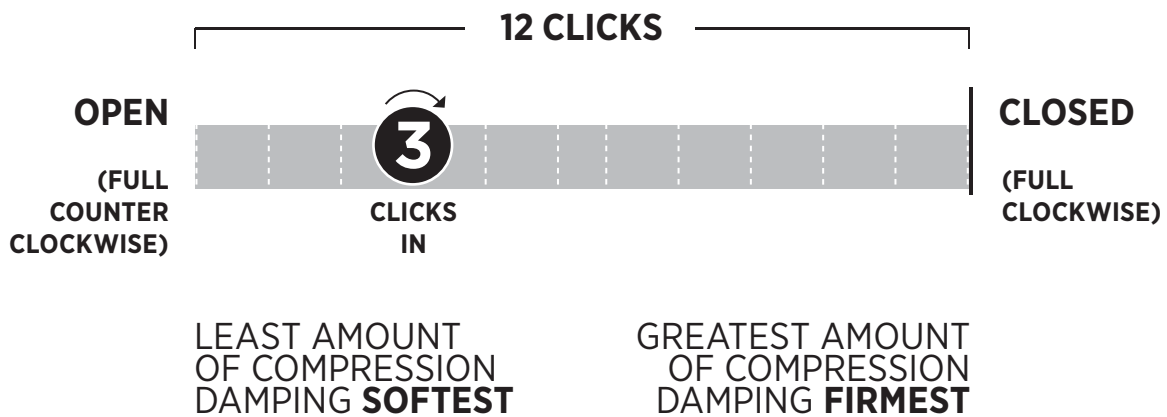

DSC LOW SPEED COMPRESSION

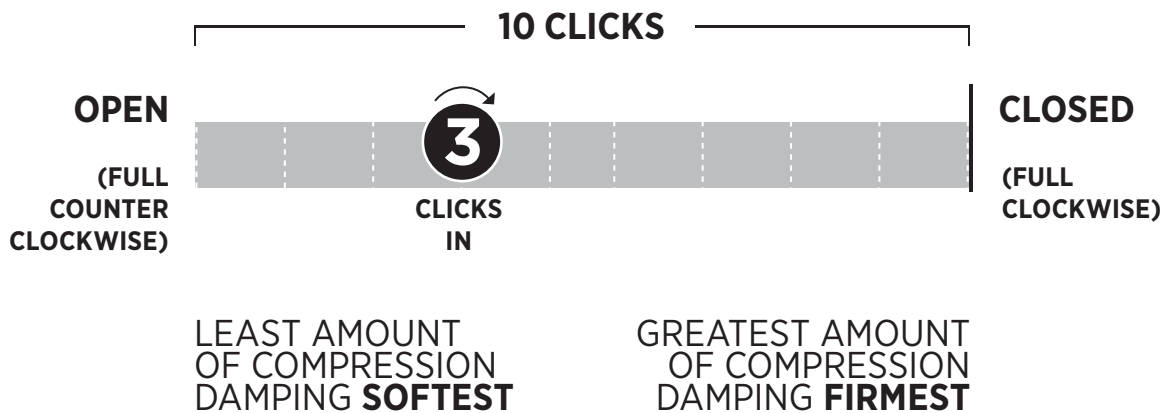

WARRANTY INFORMATION

FOX LIMITED WARRANTY

FOX Factory, Inc., a Georgia corporation having an office at 6634 Highway 53 Braselton, GA 30517 (“FOX”), makes the following LIMITED WARRANTY with respect to its suspension products:
LIMITED ONE (1) YEAR WARRANTY ON SUSPENSION PRODUCTS.

Subject to the limitations, terms and conditions hereof, FOX warrants, to the original retail owner of each new FOX suspension product, that the FOX suspension product, when new, is free from defects in materials and workmanship. Unless otherwise required by law, this warranty expires one (1) year from the date of the original FOX suspension product retail purchase from an authorized FOX dealer or from a FOX authorized Original Equipment Manufacturer where FOX suspension is included as original equipment on a purchased vehicle. If law requires a warranty duration of greater than one (1) year, then, subject to the other provisions hereof, this warranty will expire at the end of the minimum warranty period required by such law.

TERMS OF WARRANTY

This warranty is conditioned on the FOX suspension product being operated under normal conditions and properly maintained as specified by FOX. This warranty is only applicable to FOX suspensions purchased new from an authorized FOX source and is made only to the original retail owner of the new FOX suspension product and is not transferable to subsequent owners. This warranty is void if the FOX suspension product is subjected to abuse, neglect, improper or unauthorized repair, improper or unauthorized service or maintenance, alteration, modification, accident or other abnormal, excessive, or improper use.

Should it be determined by FOX in its sole and final discretion, that a FOX suspension product is covered by this warranty, it will be repaired or replaced, by a comparable model, at FOX’s sole option, which will be conclusive and binding. THIS IS THE EXCLUSIVE REMEDY UNDER THIS WARRANTY. ANY AND ALL OTHER REMEDIES AND DAMAGES THAT MAY OTHERWISE BE APPLICABLE ARE EXCLUDED, INCLUDING, BUT NOT LIMITED TO, INCIDENTAL OR CONSEQUENTIAL DAMAGES OR PUNITIVE DAMAGES.

This limited warranty does not apply to normal wear and tear, malfunctions or failures that result from abuse, improper assembly, neglect, alteration, improper maintenance, crash, misuse or collision. This limited warranty gives the consumer specific legal rights. The consumer may also have other legal rights which vary from state to state or country to country. Some states and countries do not allow the exclusion or limitation of incidental or consequential damages or warranties, and if dictated by law the above limitations or exclusions may not apply to you. If it is determined by a court of competent jurisdiction that a certain provision of this limited warranty does not apply, such determination shall not affect any other provision of this limited warranty and all other provisions shall remain in full effect.

THIS IS THE ONLY WARRANTY MADE BY FOX ON ITS SUSPENSION PRODUCTS AND COMPONENTS, AND THERE ARE NO WARRANTIES WHICH EXTEND BEYOND THE DESCRIPTION HEREIN. ANY WARRANTIES THAT MAY OTHERWISE BE IMPLIED BY LAW INCLUDING, BUT NOT LIMITED TO, ANY IMPLIED WARRANTY OF MERCHANTABILITY OR FITNESS FOR A PARTICULAR PURPOSE ARE EXCLUDED.

SHOCKS NEED LOVE TOO

FOX SERVICE AND UPGRADES

HAVE YOUR FOX SHOCKS SERVICED BY FOX TECHNICIANS. CALL OUR OFF-ROAD AND TRUCK SERVICE CENTER AT 619.768.1800 TO GO OVER THE SERVICE AND UPGRADE OPTIONS AVAILABLE FOR YOUR PRODUCT. ONCE YOU'VE SETUP YOUR SERVICE AND/OR UPGRADES YOU WILL RECEIVE A RETURN AUTHORIZATION NUMBER AND SHIPPING INSTRUCTIONS.

COMPLETE SERVICES

100% street use: every 50,000 miles

50% street/ 50% off-road use: Every 10,000 miles

SERVICE MENUS AND PRICING

visit ridefox.com/service



**WARNING: Cancer and
Reproductive Harm –**
www.P65Warnings.ca.gov

