



baja designs[®]
THE SCIENTISTS OF LIGHTING

**2005-2023, Toyota Tacoma Roof Kit
(44-8111, 44-8121)**



2950 Norman Strasse • San Marcos • CA • 92069

Phone 760-560-2252 X3 • Fax 760-560-0383

info@bajadesigns.com • www.bajadesigns.com



baja designs[®]
THE SCIENTISTS OF LIGHTING

LIMITED LIFETIME WARRANTY

Baja Designs proudly offers a LIFETIME WARRANTY against manufacturer's defect on all the products that we manufacture.

These are comprehensive warranties; other than the exclusions below – you're covered. If your LED or HID bulb burns out, you're covered. Additionally, cutting off our connector or changing your lenses does not automatically void your warranty.

Exclusions:

Installation errors, abuse, misuse, or crash damage. You must be the original owner of the product and can supply proof of purchase.

Baja Designs manufactures its own products as well as resells products manufactured by others. Baja Designs makes no express or implied warranties on products not manufactured by Baja Designs including without limitation any warranties or merchantability and fitness for a purpose. We will, however, pass on all warranties made by the manufacturer, who has sole responsibility for performing such warranties.

Baja Designs will pay the freight if your product is less than 90 days old, otherwise defective products must be returned to Baja Designs, Inc., freight prepaid. At our option, we will repair or replace items in question and return them at no charge. If the identical product is no longer available, we will replace with a similar product of equal value. Baja Designs Inc. will not be responsible for any indirect or consequential damages in connection with defective merchandise.

Items purchased through a Baja Designs authorized dealer must be returned through the dealer. Only available on LED auxiliary lights and product must be in sellable condition at MSRP. Product that has been damaged in any way after the original purchase date will be excluded from this guarantee.

Indemnification:

Buyer hereby acknowledges off-roading, racing and driving at night are dangerous activities and that the products and/or supplies purchased from Baja Designs are used in an inherently dangerous activity that may endanger life and limb; and in no event shall the seller, or seller's heirs and assigns, be held liable for consequential damages, nor shall seller's liability on any claim for damages arising out of or connected with the sale, delivery, or use of purchased products and/or supplies exceed the purchase price of the products and/or supplies.

Buyer is responsible for ensuring that it uses the products (and its vehicle) in accordance with all applicable laws, regulations, guidelines, and standards of care. Buyer acknowledges that some products may only be used when off-roading, and Buyer will comply with all vehicle and road safety guidelines. Buyer is solely responsible for (and will indemnify and hold Bestop harmless for) any claims, losses, damages, fines, fees, costs, or other amounts arising out of Buyer's non-compliance with these provisions.

Tools Required

- 7/16" Wrench and Socket
- 5mm Allen wrench
- Rivet Nut tool, or light duty impact driver
- Center punch (recommended)
- RTV, or silicone sealant
- Heavy duty scissors, or Dremel
- 10mm, 12mm, and 13mm wrench
- Trim tool or plastic prybar
- 0.125", 0.25", 25/64" Drills
- Masking Tape

To begin, make sure the vehicle is in park, on level ground and the parking brake is engaged.

1. Open the hood. Remove the negative battery cable using a 10mm wrench. With the trim tool, pry up the front edge of the passenger side roof gutter trim seal. (Arrowed in figure 1)



2. Once the trim is removed, peel back the tape over the existing OEM threaded holes (circled in figure).



3. Apply masking tape to protect paint. Bolt the passenger side bracket into the holes from step 2 using the provided **M6 socket head** hardware, washers, and the 5mm Allen wrench.



4. Mark the center of the front mounting hole and with a small drill (0.125"), create a hole. Remove bracket. Only drill through the top layer of sheet metal. ***Do not drill any deeper***. Drill again with larger bits until the final size is achieved (25/64" or 0.391"). Repeat steps 1-4 for the driver side.



****Access cab models require all holes drilled. Front edge of bracket will be 1 7/8" from the front of the gutter.****

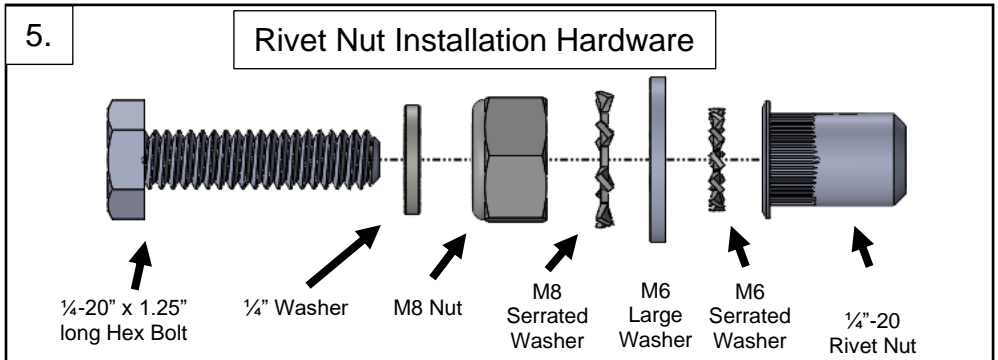

5. Assemble the rivet nut installation hardware in the configuration shown in figure 5. Apply silicone, or RTV under the rivet nut before installation. Place the rivet nut into the passenger side hole with the installation hardware.

6. Using the 7/16" socket with a light duty impact wrench (~2000 inch-pounds) set to full speed and a 13mm wrench, hold the wrench stationary on the M8 nut and operate the drill until the impact hammer clutch goes off for about 3 seconds.

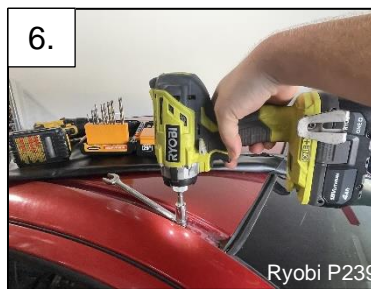

7. Apply ample sealant over all holes. Repeat for both sides. Rivet nut Installation hardware can be placed aside.



NOTE: two extra rivet nuts are included. A rivet nut installation tool can be purchased cheaply online if preferred

8. Place the included rubber gasket strip over the holes and mount the brackets with the 5mm Allen wrench and 7/16" wrench/socket.

9. Place the roof trim next to the back edge of the bracket and mark a line. Cut the trim, place sealant underneath and press firmly into roof gutter.

10. Now place the excess trim back onto the front clasp and mark where the front edge of the bracket meets the trim piece and cut. Cut one more piece to be placed in-between the bracket mounts with sealant underneath. Repeat for the driver side.

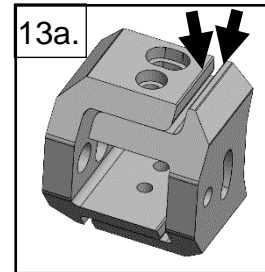
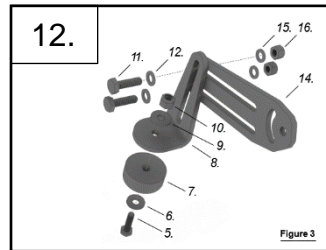
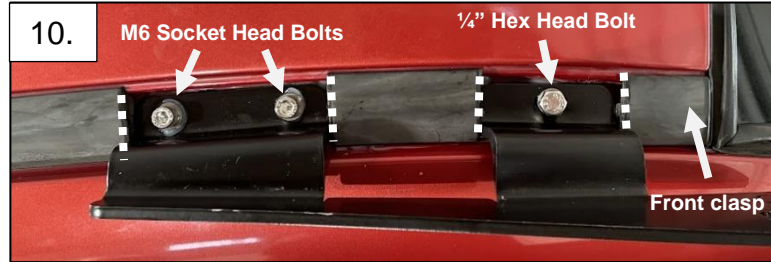
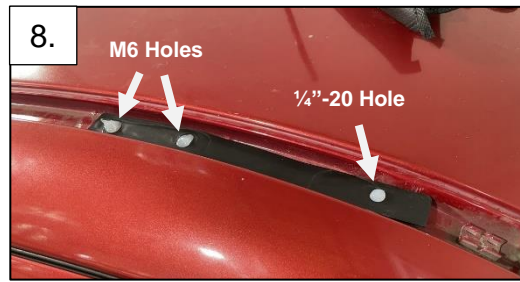

Steps 11-14 is for XL Linkable Only:

11. Place the 8 XL Linkable onto a soft work surface. With the Allen wrench provided in the XL Linkable parts bag, remove the top and bottom bolts of the center pair of links. On one of the two center lights, left or right, remove the housing bolts with the provided Allen wrench. (See XL Linkable instructions)

12. Locate the preload extension brackets with hardware. With the 7/16" wrench and socket, attach the rubber bump as shown to the base support bracket (#8 in Figure 3, XL Linkable Instructions). With the longer bolts in the support bracket parts bag, reattach the link to the light with the extension bracket (#14 in Figure 3, XL Linkable Instructions) in between the link and the light housing. Leave the bolts in the slots slightly loose for now.

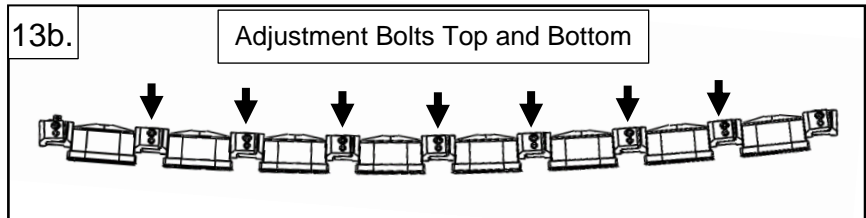

13. With the provided Allen wrench, replace the bolts from step 11 and reassemble the Linkable light bar. One at a time, loosen each pair of links (13b) and adjust so the edges are parallel as shown (13a). Tighten. The outer two pairs of links can remain loose momentarily.

14. Place something soft on the middle of the windshield. With the provided Linkable mounting hardware, Allen wrench and 7/16" wrench, mount the lightbar onto the roof brackets. Tighten. After light is operational, adjust this hardware to aim. Tighten the outer link hardware.

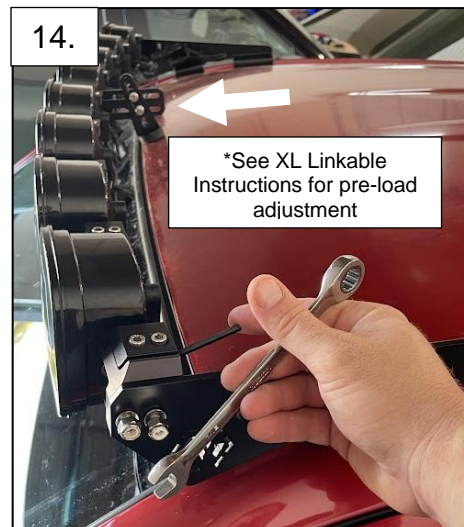

Step 15 is for OnX6+ Only:

15. With the 7/16" wrench and socket and the provided hardware, mount the OnX6+ with the power cord on the passenger side.



16. Apply the included wire hider to the passenger side of the windshield (See wire hider instructions).

17. With the light plug lead in hand, route the light lead of the harness around the wiper cowl and hood hinges and up to the light and plug in the connector. Use the existing zip tie slots and included zip ties to affix the harness to the bracket. (17b). Carefully open the wire hider and slide the harness inside.



18. Route the remaining harness along the firewall to the driver side.

19. In the cab, carefully pull to remove the lower left kick panel as shown. Choose a desired dash location from the few examples circled and confirm there is clearance behind the panel. With the 3/8" drill, create a hole.

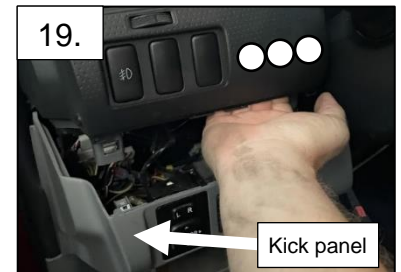
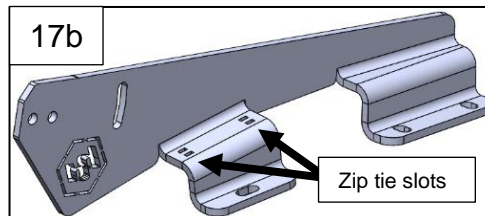

20. Take a reference photo of the switch wiring orientations and wire colors. Remove the switch, route the harness through the firewall pass through on the right of the brake booster.

21. Continue routing the switch harness through the dash and the hole from step 19. Reattach switch and mount to dash.

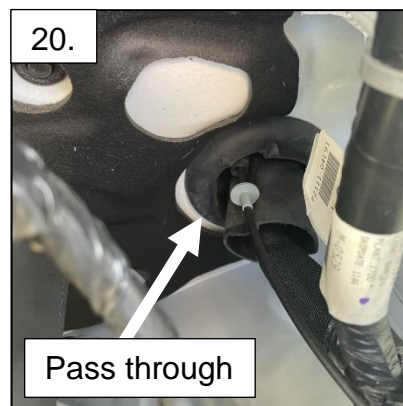

22. With the 10mm wrench, loosen the positive terminal and place the positive ring terminal of the wiring harness over the terminal and tighten. Repeat for the ground.

23. Aim the light and enjoy!

*Tie all wires away from sharp, hot, and/or rotating components.

* Re-torque all the fasteners after 100 miles.

*Your install is now complete! Thank you for choosing Baja Designs.