

INSTALL INSTRUCTIONS



HIGH-STEER KIT FOR TOYOTA SOLID FRONT AXLES INSTALLATION INSTRUCTIONS

KIT CONTENTS



HIGH STEER KIT FOR TOYOTA SOLID
FRONT AXLES ON TOYOTA VEHICLES

HIGH STEER KIT FOR TOYOTA OEM
SOLID FRONT AXLES ON SUZUKI SAMURAI



Note: If you are using the Toyota High Steer Kit with a flat pitman arm you will need to relocate your steering box forward and downward on the frame to prevent the flat pitman arm from hitting the frame. Alternatively, you may notch the frame for clearance and weld in a piece of DOM tubing as reinforcement. You will need to use an IFS Steering Box Mount Kit to move your steering box (IFS Steering Box Mount not included). Do not proceed with installing this kit until you have decided which method to use and have obtained the necessary parts.

304537-INS

INSTALL INSTRUCTIONS (CONT'D.)



RECOMMENDED TOOLS

Safety Glasses

Ratchet & Metric Socket Set

Cutting or Tapping Oil

Drill Press, Vertical Mill, or Large Tap Wrench

Tie Rod End Remover or Tie Rod Separator Fork

Torque Wrench

Adjustable Wrench

Slip-Joint Pliers

ADDITIONAL PARTS NEEDED

IFS Steering Box Mount Kit TG P/N 130004-1-KIT (For Toyota vehicles with Flat Pitman Arm only)

Toyota IFS Steering Box (For Toyota Vehicles Only)

CAUTION

1. Read all instructions completely and carefully before you begin. If anything is not clear, please call our tech support line at 1.877.4X4.TOYS or 559.252.4950 or email tech@trail-gear.com before proceeding.
2. Check to make sure the kit is complete and that no parts are missing (refer to the kit contents section on the first page). If anything is missing, please contact Trail-Gear at 1.877.4X4.TOYS or 559.252.4950 or email tech@trail-gear.com.
3. Park vehicle on a clean, dry, flat, level surface and block the tires so the vehicle cannot roll in either direction.
4. This product is for off-road use only. It is recommended that the installation steps below be performed by a competent mechanic. Buyers and users of this product hereby expressly assume all risks associated with the installation and use of this product.

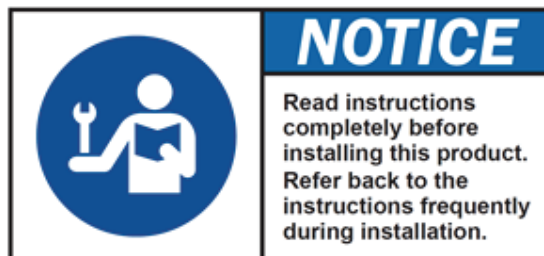

INSTALL INSTRUCTIONS (CONT'D.)



STEP 1

Unbolt and remove the stock Toyota steering arms, tie rod, and drag link. Discard the stock steering arms, tie rod, and drag link. Save the steering arm studs, nuts, wave washers, and cone washers for reinstallation.

STEP 2

Unbolt & remove the stock pitman arm. If you have a Toyota steering box, discard the stock pitman arm. If you have a Suzuki steering box, retain the stock steering arm.

STEP 3

If you have a Toyota steering box, skip to the next step. Otherwise, using the taper reamer included in this kit, carefully ream out the end of the Suzuki pitman arm to accommodate the supplied tie rod end. Ream the pitman arm until you can slide the tie rod end in, tighten the castle nut, and have the hole for the cotter pin show (see picture below). Make sure to ream slowly and use plenty of cutting or tapping oil. **Stop frequently to check the fitment with the tie rod end so that you do not ream too deeply.** The reaming tool can be mounted in a drill press or vertical mill. It can also be fitted in a large tap wrench for reaming by hand. Reinstall the pitman arm back onto the steering box.



STEP 4

If desired, you may paint the new steering arms to prevent corrosion. If you paint the steering arms, DO NOT paint the surface of the steering arm that attaches to the knuckle.

(CONTINUE TO FOLLOWING PAGE FOR STEP 5)

INSTALL INSTRUCTIONS (CONT'D.)



STEP 5 (TOYOTA VEHICLES)

Install the steering arms, tie rod ends, tie rod, and drag link as shown below. Torque the steering arm mounting nuts to 71 ft-lbs (96 N-m). Torque the tie rod end castle nuts to 80 ft-lbs (108 N-m). Adjust tie rod and drag link as needed and secure in place using the jam nuts provided in this kit. Follow the procedure in the Toyota Pickup/4Runner Factory Service Manual for measuring knuckle pull resistance and knuckle shimming. **Note: If you are using a flat pitman arm you will need to relocate your steering box forward and downward on the frame to prevent the flat pitman arm from hitting the frame, or notch the frame for clearance. We suggest using IFS Steering Box Mount Kit TG P/N 130004-1-KIT (sold separately) for relocating the steering box.**

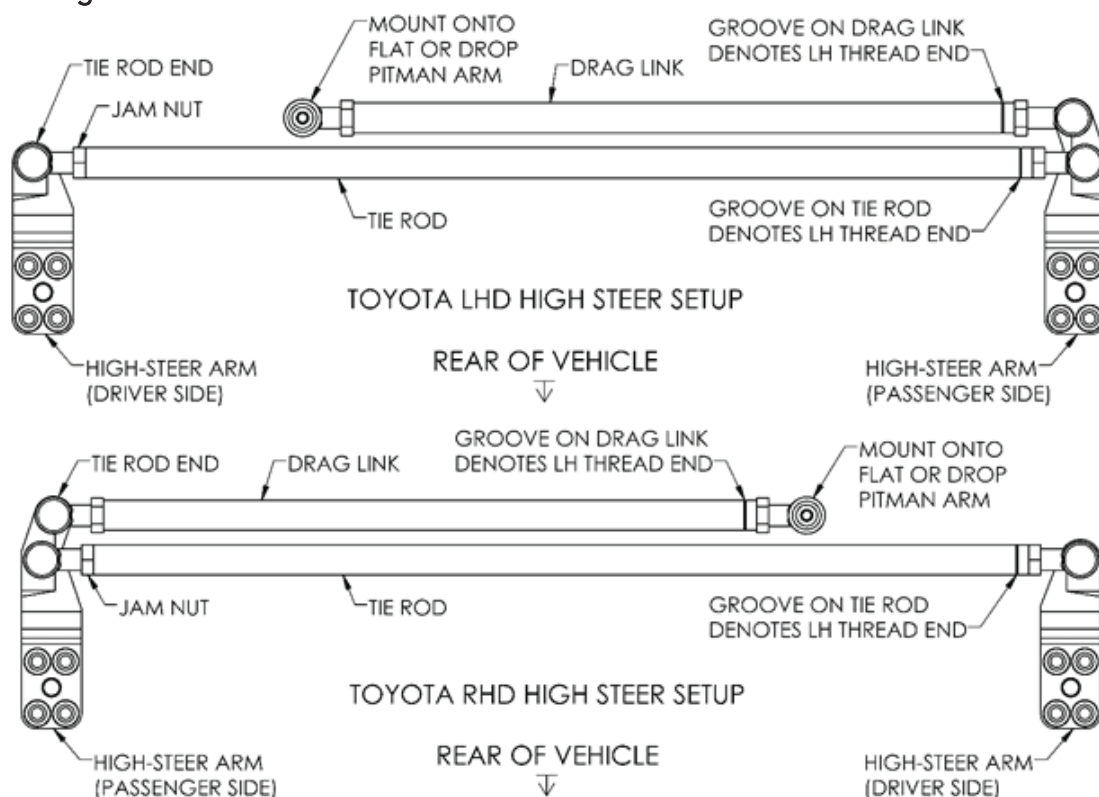

STEP 5 (SUZUKI SAMURAI WITH TOYOTA SOLID FRONT AXLE)

Install the steering arms, tie rod ends, tie rod, and drag link as shown below. Torque the steering arm mounting nuts to 71 ft-lbs (96 N-m). Torque the tie rod end castle nuts to 80 ft-lbs (108 N-m). Adjust tie rod and drag link as needed and secure in place using the jam nuts provided in this kit. Follow the procedure in the Toyota Pickup/4Runner Factory Service Manual for measuring knuckle pull resistance and knuckle shimming.

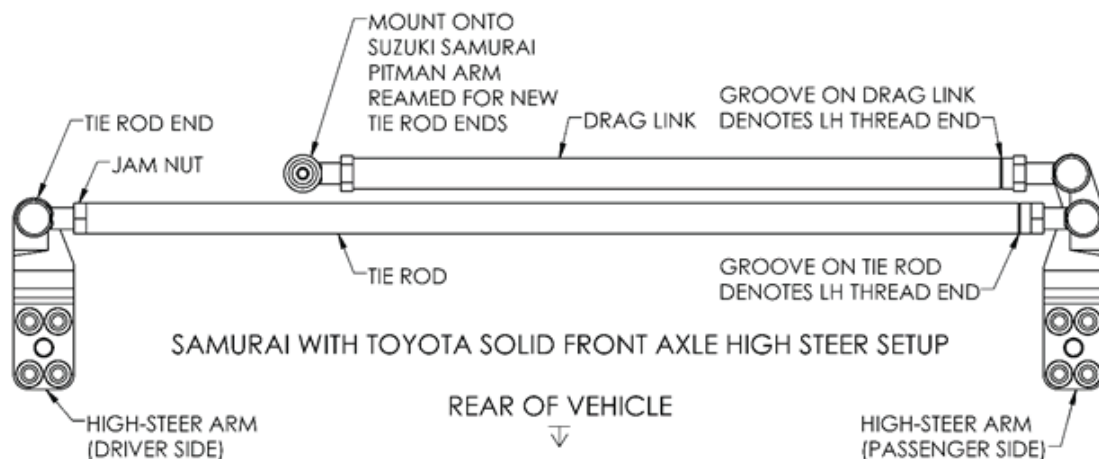

INSTALL INSTRUCTIONS (CONT'D.)



STEP 6

Install cotter pins into the holes on the tie rod ends as shown below. Bend the ears of the cotter pins to secure the castle nuts. Reassemble your front axle. Cycle the steering from lock to lock and verify that the pitman arm does not interfere with the frame or suspension components. Take the vehicle for a short test drive. Verify all hardware is properly torqued. Check the steering arm nut torque after every off-road trip and tighten as needed.



REPLACEMENT PARTS

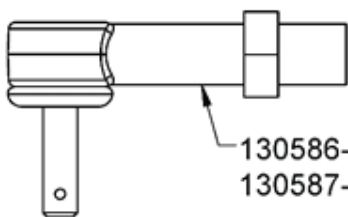

130586-1-KIT (RH THREAD)
130587-1-KIT (LH THREAD)